

WA102 Wireless Transmitter



Innovative



Rugged



Seamless



Introducing CTC's WA100 Wireless Series

CTC's WA100 Wireless series features fully molded wireless transmitters and an open network software for cutting edge data collection. The WA100 series is an ideal solution for permanent monitoring applications, eliminating the need for standard connectors, cabling, and junction boxes.

Customizable Data Collection

CTC's WA102-1A Wireless transmitters work seamlessly with CTC's WA100-TAB wireless tablet to collect data. WA100-TAB comes preloaded with CTC's wireless software. Users have the ability to nickname wireless transmitters, create transmitter groups according to the monitoring application, and customize reading settings.



BLE 5.0 wireless communication



150 ft. Line-of-Sight range



Fully-molded, IP67 rated design protects electronics from dust, dirt and water making it ideal for a wide variety of industrial applications



Lowers the cost for permanent monitoring installations by eliminating the need for standard connectors, cabling and junction boxes



Compatible with CTC AC312 and AC314 Low Power sensors



4+ years estimated battery life when taking 2 or less readings per day in standard operating conditions



Own your data - no recurring or hidden software fees



Easily add on more wireless transmitters to your monitoring program



Backed by the PRO Line's lifetime warranty on materials* and workmanship



Designed and built in the USA



*Battery end-of-life failure is not covered under material warranty

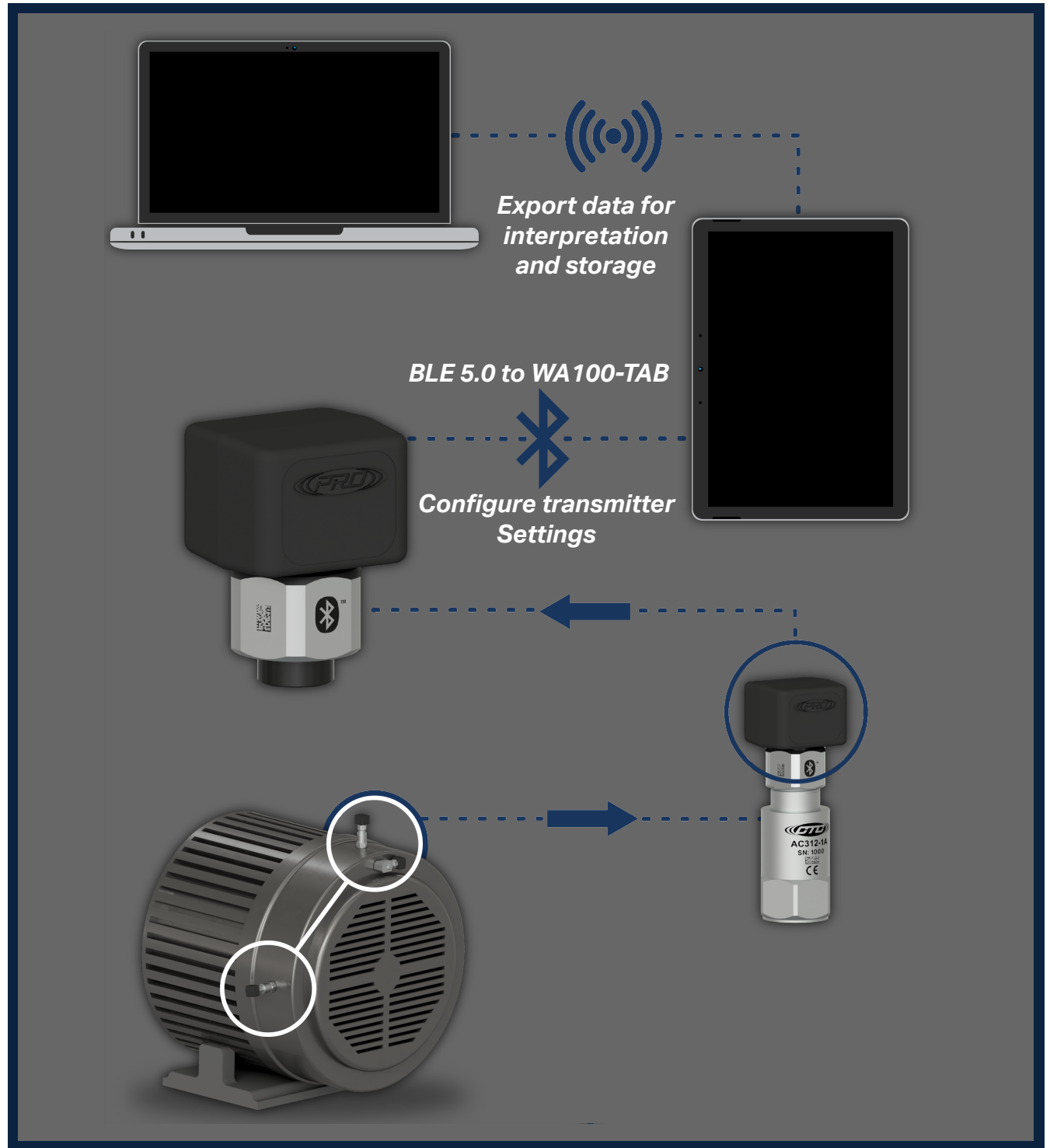

Frequently Asked Questions

Will my tablet still receive data if there are obstructions between the tablet and the transmitter?

BLE Bluetooth signals will allow for some level of obstructions. The material composition of obstruction will determine the level of signal loss. We have seen moderate signal loss with materials like drywall, and complete signal loss with other materials like reinforced concrete. Any obstructions will produce some level of signal loss and reduce the maximum distance you are able to receive data within. For best performance, Line-of-Sight is recommended.

Does the transmitter store data?

The access point/receiver is the primary storage location of data. The transmitter only stores 1 reading at a time, once this reading is transmitted to the receiver it is overwritten with the next reading.

Is the battery on my WA100 Series transmitter replaceable or rechargeable?

No, WA100 Series transmitters are disposable units. The molded design seals the transmitter from the environment, and therefore does not allow for replaceable or rechargeable batteries.

Will my WA100 tablet talk to my data analyzer?

Various analyzers support data import. The CTC Wireless Software that runs on our tablet and access point will provide the data in a variety of common formats that can be used for data import/export.

What format is my data stored in?

The raw data is fed through Bluetooth Characteristics, the software converts the raw Bluetooth data to a JSON file format which is fed into a Microsoft SQL Database.

How many readings will my tablet store?

Out of the box, the tablet will store over 100,000 readings. The number of readings is only limited by the storage space of the tablet. Storage is expandable through the Micro SD slot.



GTD
AC312-1A
SN: 1000
CE