

# EASY-LASER®

*Fits almost any kind of sheave!*

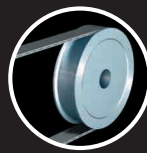

V-BELT



FLAT BELT

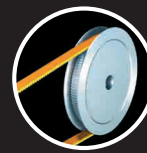

TIMING BELT



CHAIN DRIVES

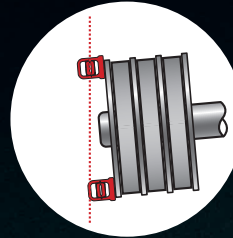

MISALIGNED

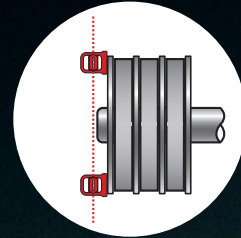

ALIGNED

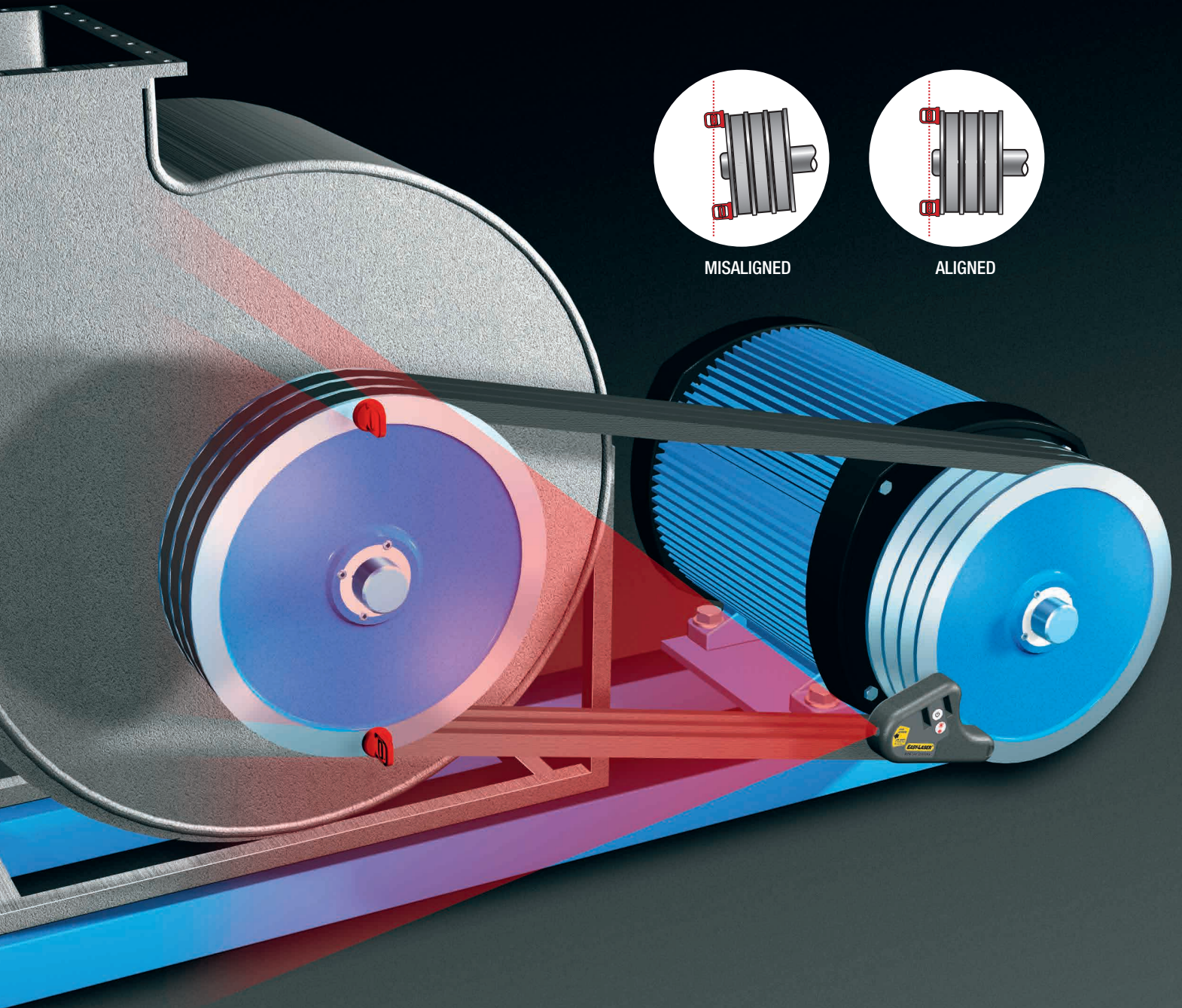

## Belt Alignment

- Shows the parallel and angular misalignment between the sheaves
- For both horizontal and vertical mounted machines
- Much faster and more accurate than measurement by earlier, conventional methods
- Alignment can be made by just one technician
- Also suitable for non-magnetic sheaves

# D92

**EASY TO USE**

The tool is attached in a few seconds, and you can easily see the laser line projected onto the targets. When the line lies in the slots of the targets, the machine is in the right position. The result is a fast, precise alignment.

**ALIGNMENT SAVES MONEY**

When aligning with the Easy-Laser® BTA you reduce the wear on sheaves/pulleys, belts, bearings and seals as well as reducing vibration. Increased efficiency also means large energy cost savings. Especially transmissions with two or more belts, or wide belts, are highly affected by misalignment, causing large differences in belt tensions and also increased wear and tear on belt edges.

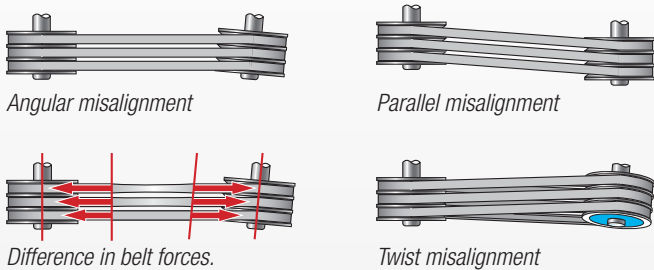

(Example of pulley alignment.)

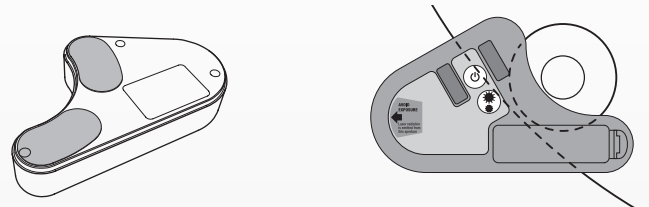
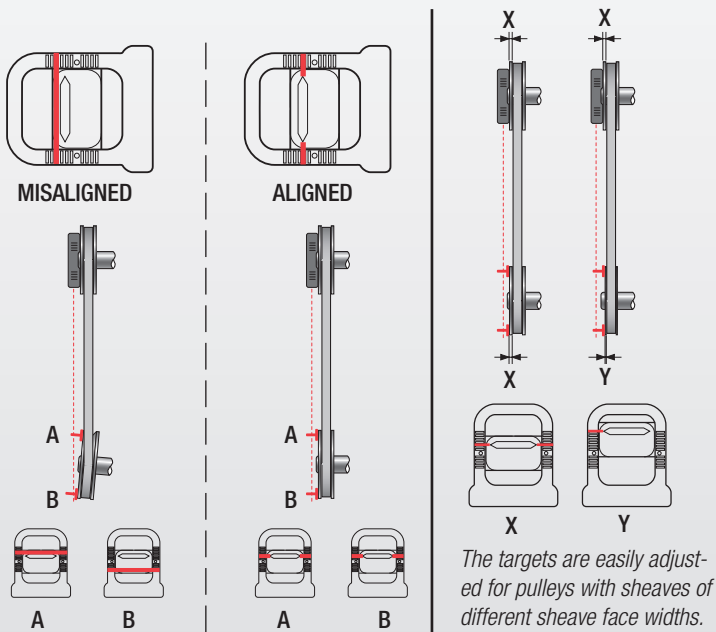

Magnetic reference surface for easy attachment to the sheaves. On non-magnetic sheaves the units can be easily clamped to the sheaves with any simple clamping device.

Carefully conceived design lets the units fit small as well as large sheaves.

**Easy-Laser® D92 BTA, Part No. 12-1332**

- 1 Laser transmitter
- 2 Targets
- 1 Padded case
- 1 Manual
- 1 Battery R6 (AA) 1.5 V

**Laser transmitter**

Sheave diameters	2.5" [60 mm] and larger
Measurement distance*	1.6" to 10' [40 mm to 3 m] (LOW power mode) 20" to 33' [0.5 m to 10 m] (HIGH power mode)
Laser class	2
Output power (average)	< 0.6 mW (LOW power mode) < 4.8 mW (HIGH power mode)
Laser wavelength	635-680 nm
Beam angle	60°
Accuracy	Laser plane – Reference plane: Parallelity: < 0.05°, Offset < 0.2 mm [0.008"]
Battery type	1xR6 (AA) 1.5 V
Battery operation	Up to 12 hours continuously
Material	ABS plastics / Hard anodized aluminium
Dimensions	WxHxD: 5.7x3.4x1.2" [145x86x30 mm]
Weight	9.35 oz [265 g]



Small, padded transportation bag fits easily in any tool case.



Belt clip on back side.

Easy-Laser® is manufactured by Easy-Laser AB, Alfagatan 6, SE-431 49 Möndal, Sweden  
 Tel +46 31 708 63 00, Fax +46 31 708 63 50, e-mail: info@easylaser.com, www.easylaser.com  
 © 2022 Easy-Laser AB. We reserve the right to make changes without prior notification.  
 \*NOTE: The useful measurement range may be shorter in bright ambient light conditions.  
 Easy-Laser® is a registered trademark of Easy-Laser AB. Other trademarks belong to the relevant copyright holder.  
 05-1028 rev1



**LUDECA**

Keep it running.

LUDECA Inc.  
 1425 N.W. 88th Avenue  
 Doral, FL 33172  
 Phone: (305) 591-8935  
 Fax: (305) 591-1537  
 info@ludeca.com  
 www.ludeca.com